



SAPPEE

# AUTOGLYM RALLY

15.-16.7.2016  
KANGASALA FINLAND

In the middle of July the Autoglym Rally is run on famous gravel stages of 1000 Lakes Rallies.

To the Winner!



[www.pr-racing.fi](http://www.pr-racing.fi)



EXIDE

decens

TASO RAKENNUS

tampereen lattia<sup>+</sup>mestari<sup>+</sup> oy  
Lattatuote ja -palvelu



RAUTIA  
KAUKAJÄRVI



Luoman Oy

YP  
Yliinen Partners Oy



WETBARON

AUTORACING

KAASUJALKA



## Autoglym Rally 15.-16. of July 2016

Rally club PR-Racing from Tampere, Finland, is a traditional rally event organizer with high experience of testing events. [www](http://www.pr-racing.fi)

Start of the event will be at Mobilia car museum area in Kangasala, where is located also Rally Hall of Fame museum.

Rally route covers total of 8 stages and 100 SS kms with 4 stages driven twice. During the rally there will be 5 service breaks in Sappee.

Demanding and fast rally route with good service options are offering great testing event for both professional teams and private drivers.

In the Sappee area there are nice hotel rooms and quality summer houses available. The accommodation to the area needs to be booked by the end of May 2016.



[www.pr-racing.fi](http://www.pr-racing.fi)

### Contact:

Erkki Tiainen

[tiainen.racing@gmail.com](mailto:tiainen.racing@gmail.com)



Luoman Oy



NETBARON





# Schedule

## Friday 15.07.2016

08.00-18.00 Reconnaissance

17.00-22.00 Shakedown Luopioinen

## Saturday 16.07.2016

09.01 Start Mobilia Kangasala



## Service/Finish Sappee Pälkäne

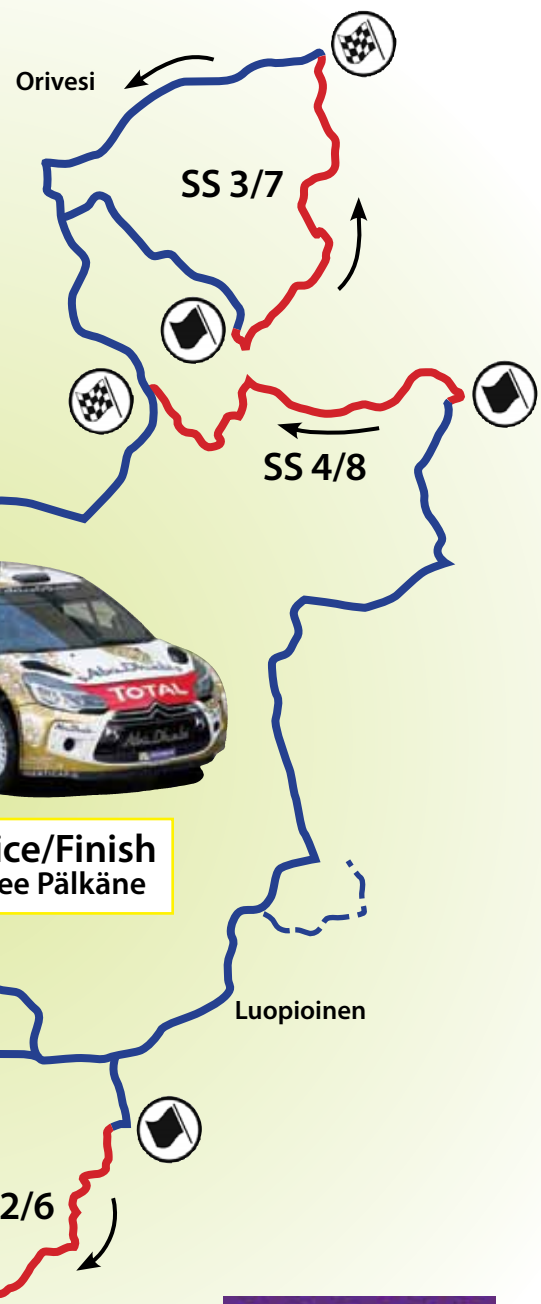
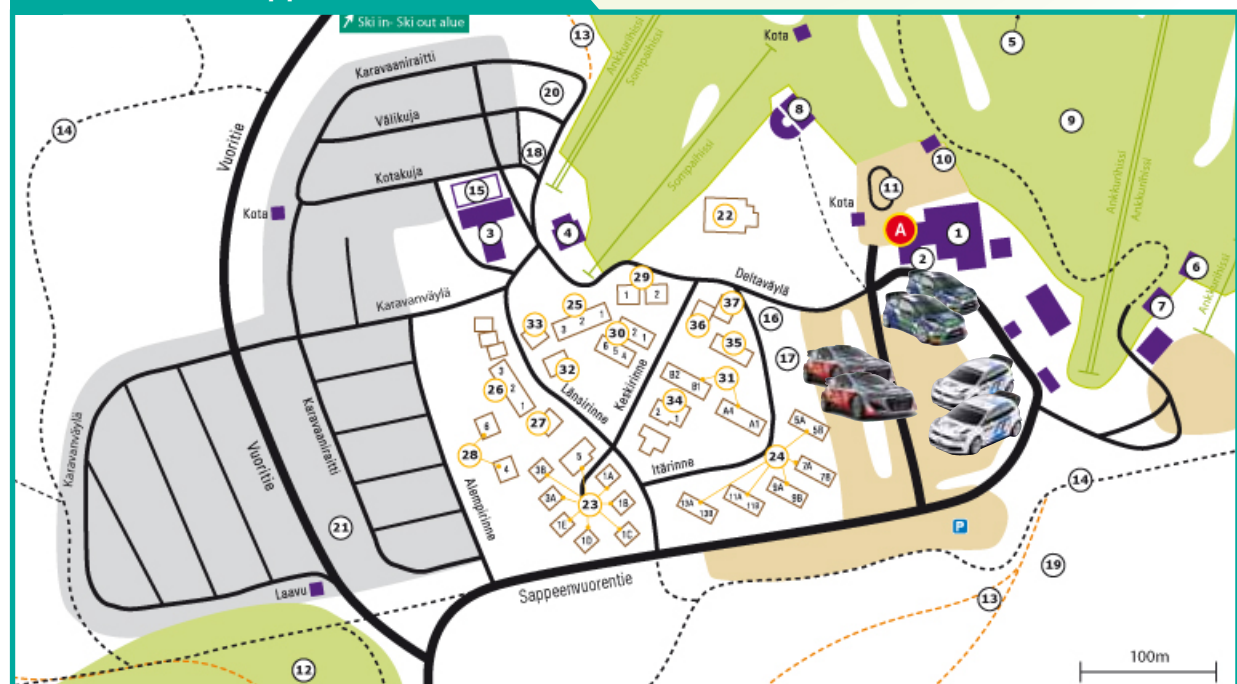

*Sappee is a versatile travel destination that keeps the whole family busy with its extensive selection of things to see and do all year round.*

# SAPPEE all-year travel destination!

*All of Sappee's services, including accommodation, restaurants, ticket office and ski equipment rental, are located on the top of the slopes amidst beautiful scenery. Sappee is ideally located only 50 km from Tampere, 160 km from Helsinki, 65 km from Hämeenlinna and 180 km from Turku.*



## Sappee Chalets

The stylishly furnished Sappee Chalets apartments are excellently located at the top of Sappeenvuori, in the immediate vicinity of Event Centre Huippu.

Holidaying is effortless when staying at the Chalets: you are only a step away from the hiking trails, cross-country skiing tracks, slopes and Sappee's services. Every detail has been carefully considered in the Chalet's suites. Finnish nature and timelessness are the starting points for the design.

**Read more >> [www.sappee.fi/en/accommodation/sappee-chalets](http://www.sappee.fi/en/accommodation/sappee-chalets)**

## accommodation

### Rental cabins

Sappee and its immediate surroundings offer a wide variety of accommodation options. You can choose to stay in the middle of the hustle and bustle or pick something a bit further away from it all. There are luxury cabins as well as those suitable for a slightly more modest taste.

Even for a larger party, there is plenty of room. All accommodations are in good condition, well maintained and well equipped. Most cabins are located only a short distance from the slopes and restaurant services.

All cabins are easily accessible by car. A suitable accommodation can be found to suit all wallets. And it is also possible to get someone to look after your children – just remember to book in advance.

**Read more >> [www.sappee.fi/en/accommodation/rental-cabins](http://www.sappee.fi/en/accommodation/rental-cabins)**



## restaurant services

At the Huippu slope restaurant you can enjoy a delicious, low-price lunch from the buffet or select your desired meal from the menu. And is there any better way to finish a meal than with a steaming cup of coffee accompanied by a fresh pastry? Event Centre Huippu is fully licensed.

**Read more >> [www.sappee.fi/en/restaurants-all](http://www.sappee.fi/en/restaurants-all)**

Vohvelikahvila (Waffle Café) is located just steps from the top station of the family slope, the Waffle Café serves customers regularly on the weekends and daily during peak season. In addition to mouth-watering waffles, the menu includes sausage with chip, hamburgers, doughnuts and sweets. The Waffle Café is also suitable for smaller meetings, events or parties.

**Read more >> [www.sappee.fi/en/waffle-cafe](http://www.sappee.fi/en/waffle-cafe)**

## SAPPEE

### Inquiries and bookings:

**+358 20 755 9575**

[sappee@sappee.fi](mailto:sappee@sappee.fi)  
[www.sappee.fi](http://www.sappee.fi)

